

Duty Stations of the 1st Infantry Regiment during the War of 1812: Original plans, diagrams or drawings of 1st Infantry posts.

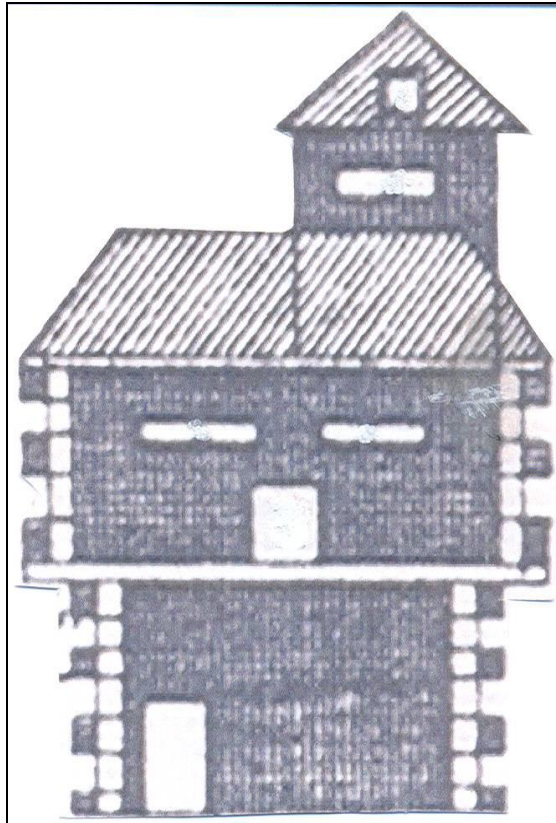

1) Fort Dearborn, Chicago, Indiana Territory, Block house detail. Drawn by Capt. Whistler, January 25, 1808.

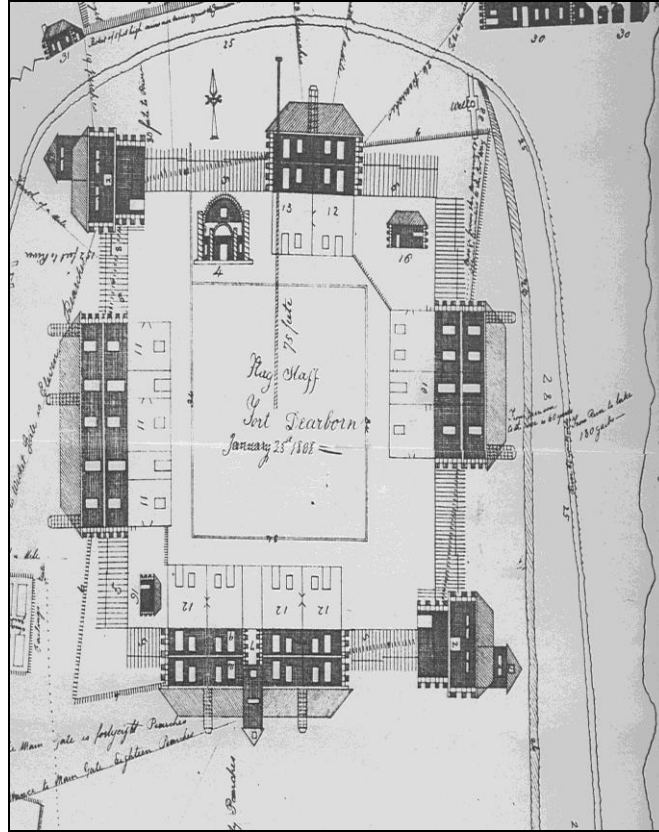

2) Fort Dearborn , Chicago, Indiana Territory. Drawn by Capt. Whistler, January 25, 1808.

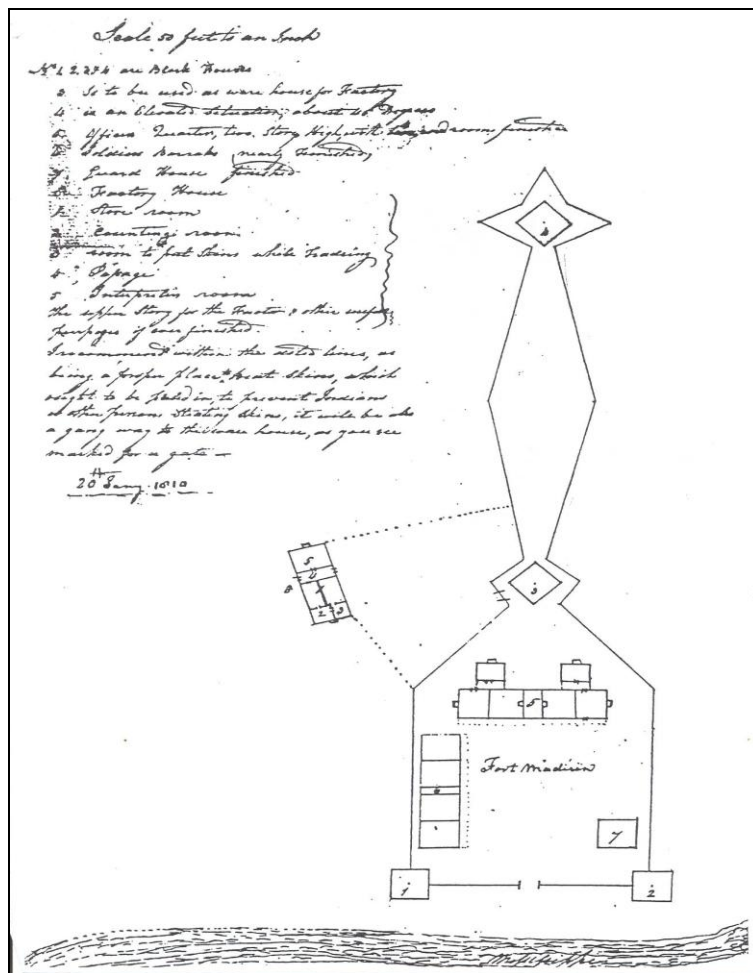

3) Fort Madison, Missouri Territory, current day Iowa. Circa 1810.

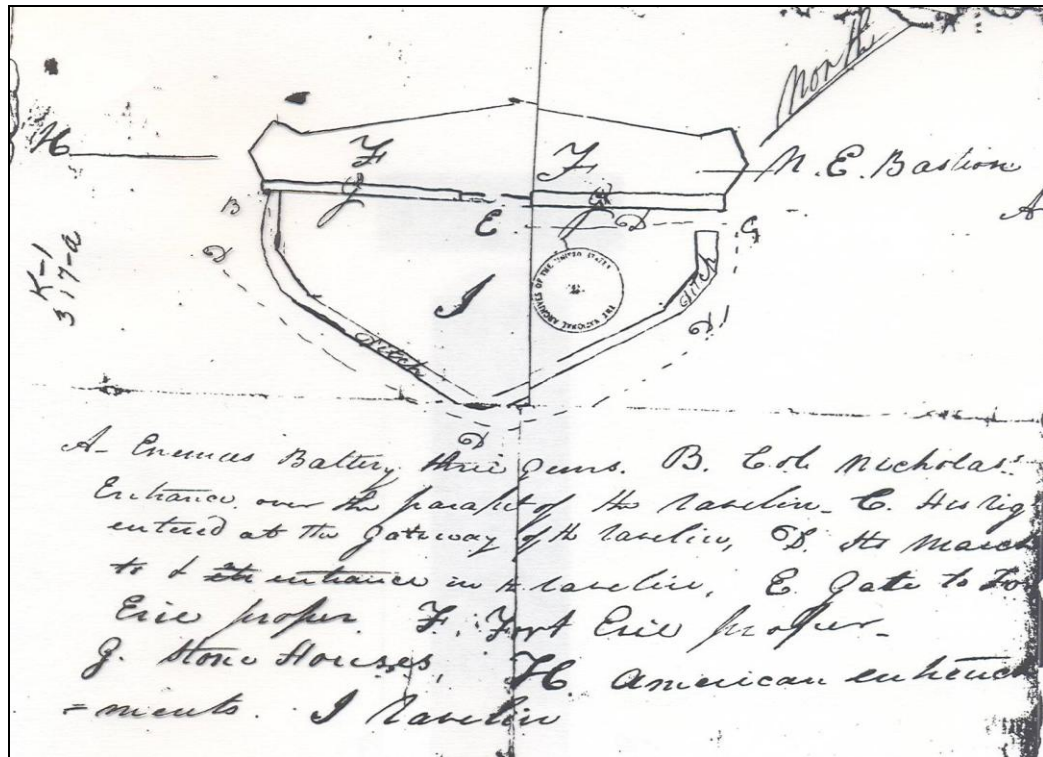

4) Fort Erie, Canada. Circa 1815, drawn for the court martial of Colonel Robert C. Nicholas, late of the 1st Infantry.

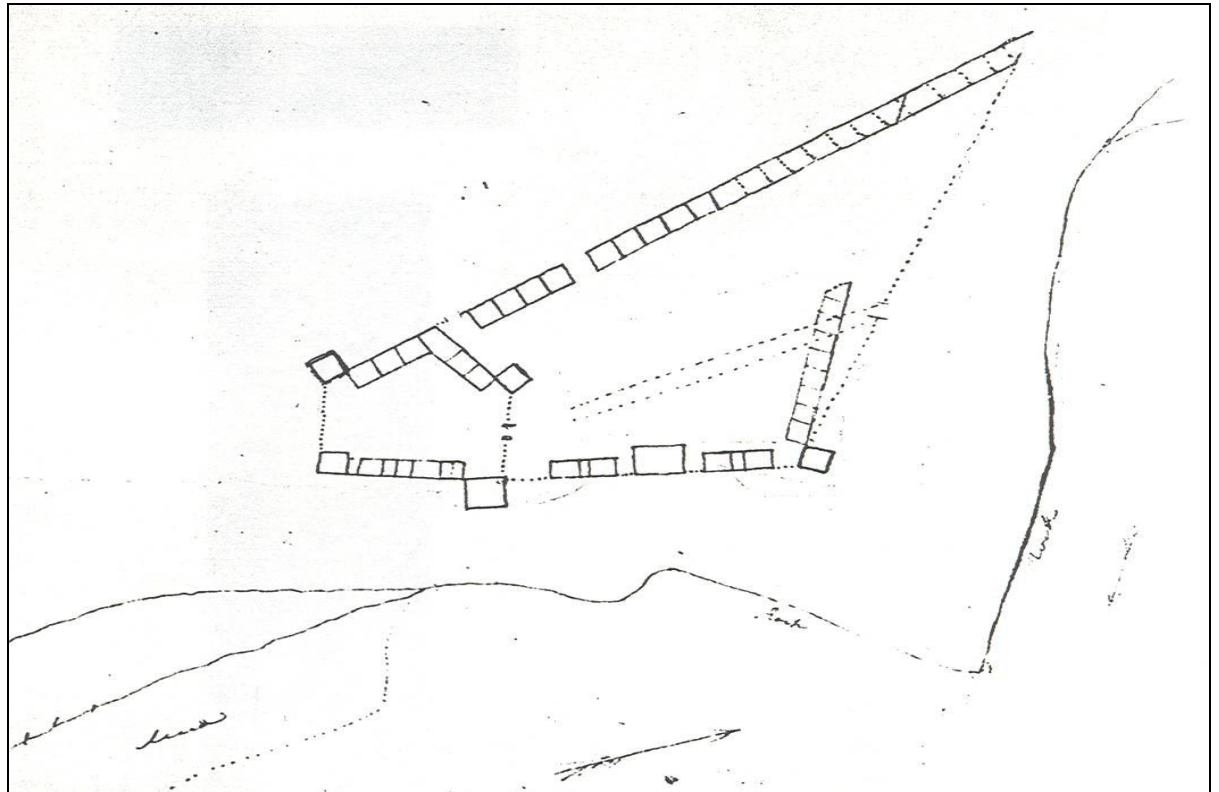

5) Fort Osage, Upper Louisiana Territory (renamed in 1812 to Missouri Territory). Drawn by William Clark, September 5, 1808.

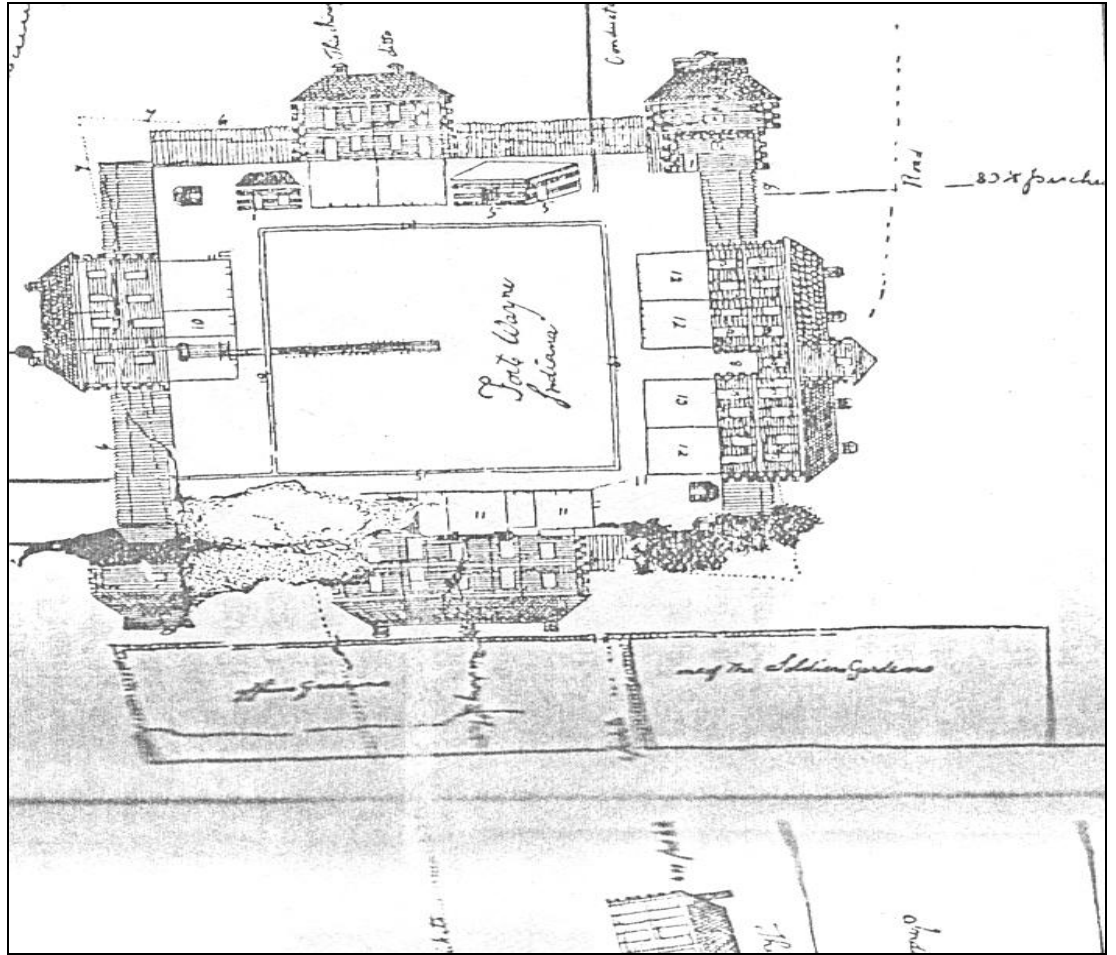

**6) Fort Wayne, Indiana Territory. Drawn by Brevet Major Whistler, ca
1815**

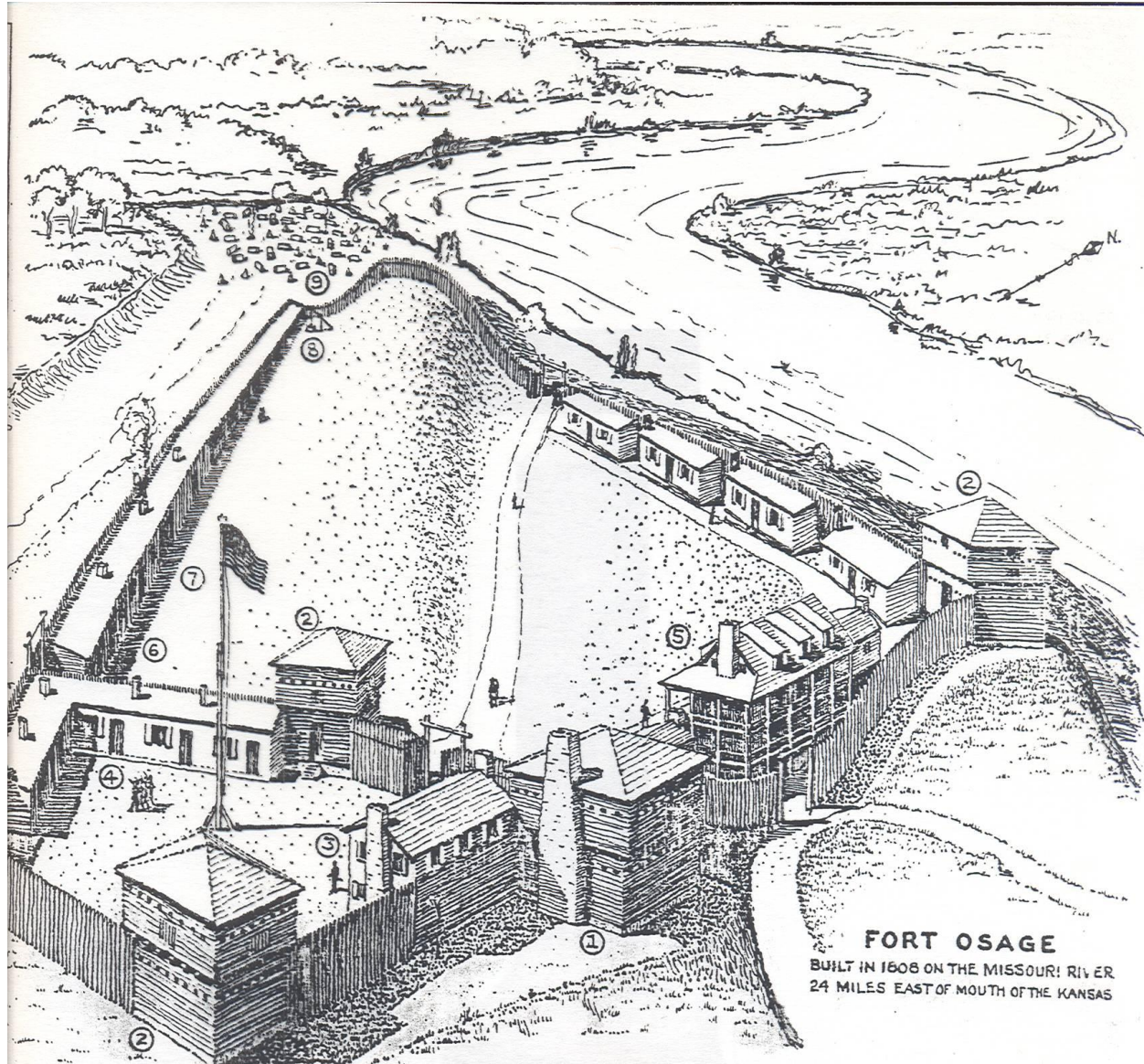

7) Fort Osage, Illustration by Fuller Green.

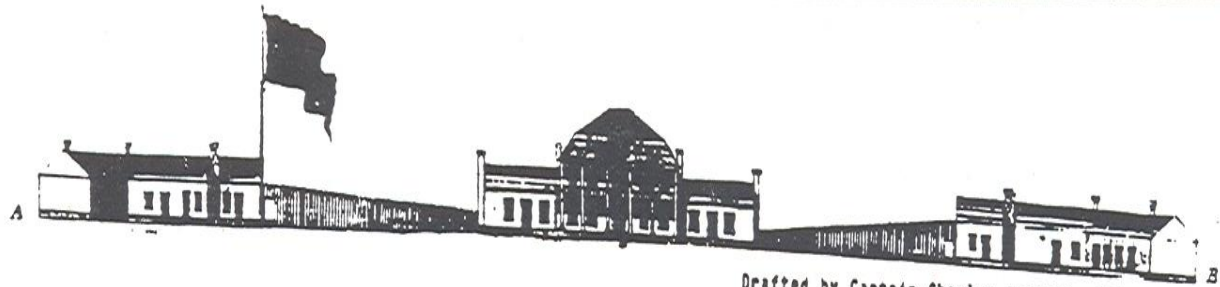

Drafted by Captain Charles Gratiot. 1812
Courtesy of Historical Society Of Pennsylvania

8) Fort Belle Fontaine, North of St. Louis, on the Missouri River.